

Can - Ada Road

Total land area = 54,159 SF
 Total building area = 18,857 SF
 % covered = 34.8%
 Parking req'd for medical = 2520 SF / 150 = 17 spaces
 Parking req'd for office = 16,337 SF / 400 = 41 spaces
 Parking needed = 58
 DEC Parking shown = 64
 T-O Parking shown = 62
 Cross access parking typical.
 Handicapped spaces req'd = 3
 Handicapped spaces shown = 4

proposed
 Wells Fargo Bank

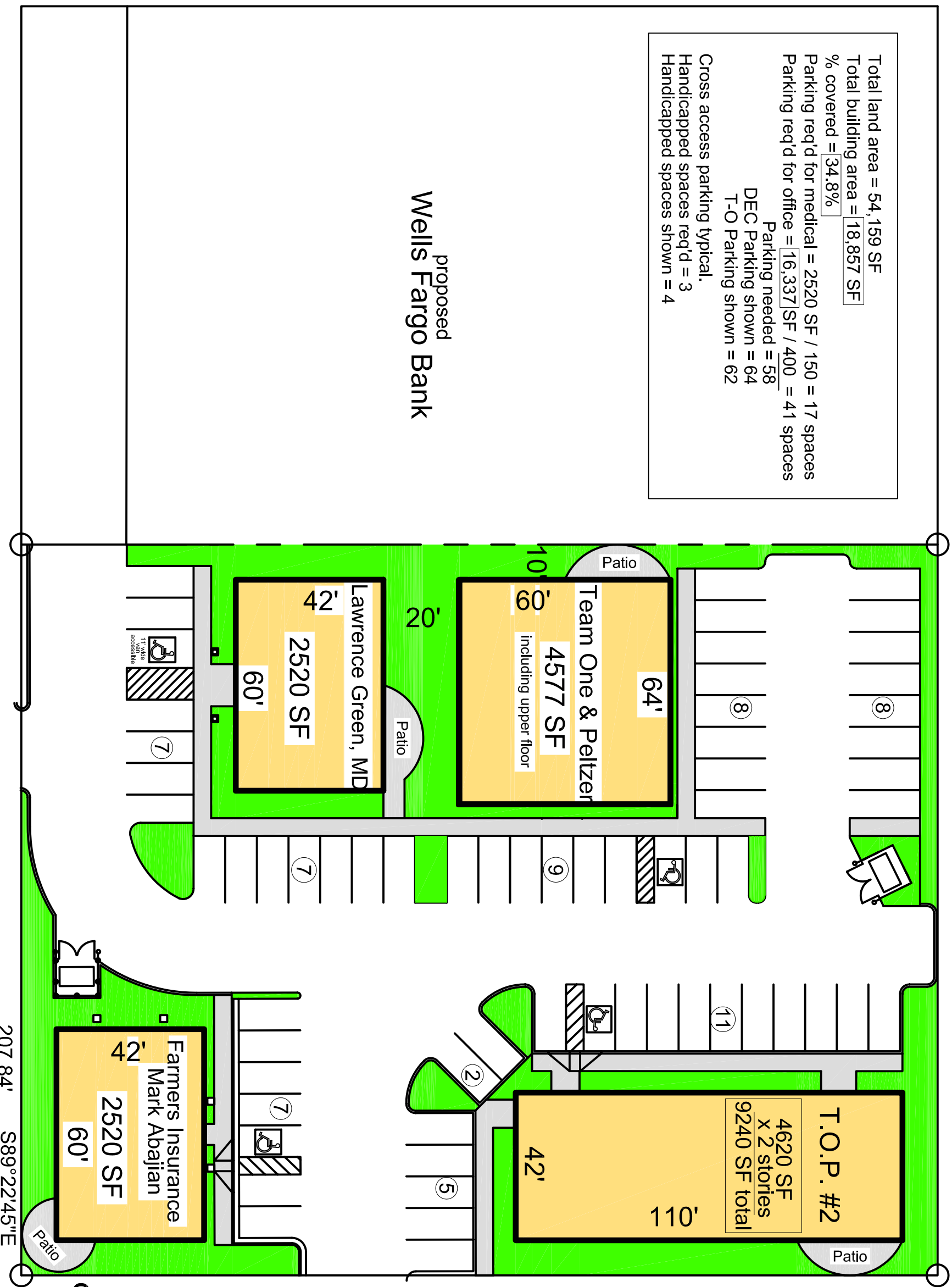

Idaho Center Business Park

Scenario #21 November 24, 2005

Chevron station

This drawing is preliminary & subject to change.

to Franklin Road

Concept Plan

Scale: 1" = 30'

Hampton Inn
 Parking Lot

existing
 Hampton Inn



5561 N. Glenwood ST
 Boise, ID 83714

Office 853-1203 Fax 853-1220
 devansconstruction.com

